

## PIC-MSM-328 Flatpack Magnet

### Data

<b>Housing Material</b>	PA6, black	
<b>Orientation</b>	over housing length 28.5 mm	
<b>Remanence Br</b>	mT	1105
<b>Coercivity HcB</b>	kA/m	836
<b>Coercivity HcJ</b>	kA/m	1274
<b>Energy Product (BH) max.</b>	kJ/m <sup>3</sup>	235
<b>Magnetic Moment M</b>	x10 <sup>-5</sup> Vs cm	3.42
<b>Operating Temperature max.</b>	°C	85
<b>Temperature Coefficient Tk(Br)</b>	%/°C	-0.11

Nominal values unless otherwise specified

### Dimensions

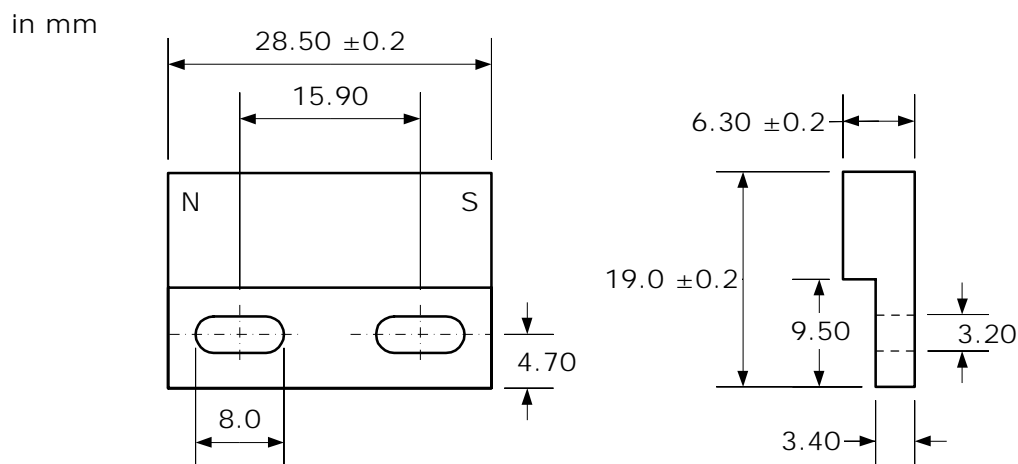

**Customized types, other magnet materials and high temperature grades available.**